

baby bullet®

QUICK START GUIDE

Making Large Batches of Fruit and Vegetable Purées

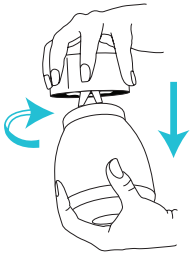

- 1 Twist the **Baby Blend Blade** on to the bottom of the **Batchbowl** for puréeing large batches of baby food.
- 2 Add thoroughly steamed or soft-boiled fruits/vegetables after they cool completely into the **Batchbowl** making sure any skins, cores, pits or stems have been removed.
- 3 Add 1/8-1/4 cup breast milk, prepared formula, or water (you can always add more if you like a thinner purée).
- 4 Place the lid onto the **Batchbowl** and twist into place.

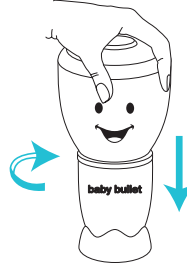

- 5 Place the **Batchbowl** onto the **Power Base**, push down and twist to engage the motor.
- 6 Blend your food until you've achieved the desired consistency. Use the Pulse Technique (page 28) for creating textured foods.



- 7 Spoon your purée into the **Date-Dial Storage Cups** to store in the refrigerator. Don't forget to set your date.



- 8 Or, for longer term storage, spoon your purée into the **Batch Tray**, snap on the lid, and freeze.

Making Smaller Batches of Fruit and Vegetable Purées

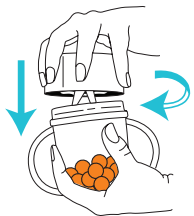

- 1 Add thoroughly steamed or soft-boiled fruits/vegetables, after cooling completely, to the **Short Cup**, making sure that any skins, cores, pits or stems have been removed.
- 2 Add 1/8-1/4 cup breast milk, prepared formula or water (you can always add more if you like a thinner purée).

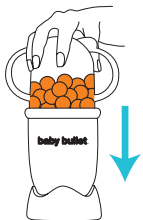

- 3 Twist the **Baby Blend Blade** onto the **Short Cup**.
- 4 Place the **Short Cup** onto the **Power Base**, push down and twist to engage the motor.



- 5 Blend your food until you've achieved the desired consistency.
- 6 Either place into a bowl and serve or spoon your purée into the **Date-Dial Storage Cups** to store in the refrigerator.



- 7 For long term storage, spoon your purée into the **Batch Tray**, snap on the lid and freeze.

ALWAYS use clean hands, clean cooking utensils, clean preparation surface(s), clean pots/pans, etc., when making and preparing homemade baby food. Cleanliness is VERY important when making homemade baby food.

Note: Refrigerated foods must be consumed within 3 days. Frozen foods are good for up to 3 months.



baby bullet®

QUICK START GUIDE

THESE SAFETY GUIDELINES ARE INTENDED FOR QUICK REFERENCE ONLY. CAREFULLY READ ALL INSTRUCTIONS IN YOUR USER MANUAL BEFORE OPERATING YOUR BABY BULLET®. SAVE THESE INSTRUCTIONS.

GENERAL SAFETY

Close supervision is necessary when any appliance is used by or near children. Keep cord out of reach of children.

Always operate the **Baby Bullet®** on a level surface, leaving unobstructed space beneath and around the Power Base to permit proper air circulation. Slots on the bottom of the Power Base are provided for ventilation to ensure reliable operation and to prevent motor over-heating.

Periodically inspect all **Baby Bullet®** components for damage or wear that may impair proper function or present an electrical hazard. Assure that power cord and plug are undamaged. Discontinue use and replace Blending Containers if you detect cracking, crazing, cloudiness or damage to the plastic. Assure that the Blades rotate freely and that the gasket is seated and undamaged. Assure that Power Base switch actuators are unobstructed, clean, and depress easily. Follow maintenance in User Manual and never operate your **Baby Bullet®** with damaged components. If your **Baby Bullet®** malfunctions in any way, immediately discontinue use and **contact Baby Bullet® Customer Service at (800) 500-0675.**

HEAT AND PRESSURE SAFETY

WARNING: TO AVOID PERSONAL INJURY, NEVER BLEND HOT INGREDIENTS OR LIQUID IN ANY CLOSED-TOP BLENDING CONTAINER OR PITCHER!! Heated ingredients can pressurize sealed containers when agitated and violently expel hot contents upon opening. Always start the blending process with room temperature or refrigerated ingredients and liquids (21°C/70°F or cooler).

WARNING: Never Continuously Operate for Longer Than Necessary to Create a Puré — generally less than one-minute. Blade friction from prolonged operation can heat ingredients and generate internal pressure in the sealed container. **If the Blending Container is warm to touch, allow to cool. Slowly unscrew the Blade Assembly from the Blending Container, pointed away from your face and body, to release any residual pressure.** Pressure can cause the blended contents to erupt from the Container, resulting in possible personal injury or property damage.

WARNING: Never Blend Carbonated Liquids or Effervescing Ingredients (e.g., baking soda, baking powder, yeast, etc.). Pressure from released gases can cause a sealed Blending Container to burst, resulting in possible injury or property damage.

Sugar in fruits and vegetables can ferment over time, releasing gases and causing pressure to build up in a sealed Blending Container. If your baby will not consume the purée immediately, remove the Blade, place food in Date-Dial Storage Cups for refrigeration or Batch Tray for freezing. **Never store any blended mixture in a sealed Blending Container either unrefrigerated or for any prolonged period of time; contents will spoil and ferment.**

BLADE SAFETY

BLADES ARE SHARP! HANDLE CAREFULLY. Use care when handling any Blade. To avoid laceration injury, do not handle or touch any Blade edge.

To Prevent Leakage and the Possible Separation of Components During Operation, properly align and securely attach (hand tighten) the Blade to a Blending Container, and check for leakage before placing it on the Power Base and operating your **Baby Bullet®.**

Never Store any Blade in the Power Base unless attached to a Blending Container. An exposed blade can present a laceration hazard.

ELECTRICAL SAFETY

When using any electrical appliance, basic safety precautions should always be observed, including the following:

To avoid risk of electric shock, never immerse the Cord, Plug, or Power Base of blender in water or other electrical current conducting liquids. Discontinue use if the Cord, Plug, or Power Base is damaged.

Do not use this product **in locations with different electrical specifications or plug types. Do not operate** with any type **of plug adapter or voltage converter device, as these may cause electrical shorting, fire, electric shock, personal injury or product damage.**

Your Baby Bullet® has a **US/Canadian** configured polarized plug (one prong is wider than the other) to reduce the risk of electric shock. This plug will correctly fit in a polarized outlet only one way. If the plug does not fit fully in the outlet, reverse the plug. If it still does not fit, contact a qualified electrician. For your safety, do not modify the plug or Motor Base in any way.