

# MAKING A SOUPERBLAST COULDN'T BE EASIER!

**Important USAGE, SAFEGUARDS and CAUTIONARY information.**  
**READ CAREFULLY**



**1** **SCREW** the **EXTRACTOR BLADE** onto the base of the **SOUPERBLAST PITCHER**.\* Add ingredients and liquid. **NOTE: LIQUID MUST BE ADDED FOR PROPER EXTRACTION.**

**2** **SECURE** the **2-PIECE VENTED SOUPERBLAST LID** on top of the pitcher.

**3** **TURN** on the **NUTRIBULLET Rx** by pressing the power button, located 90° to the left side of the G-button. The power button will glow **BLUE**, signifying power.

**4** **PLACE** the pitcher blade-side-down onto the **POWER BASE** to initiate **SMART TECHNOLOGY** and cause the G-Button to glow **GREEN**. Within 1 minute of extraction, press the G-Button for 2 seconds. The button will glow **RED**, indicating activation of the **7- MINUTE HEATED CYCLE**.

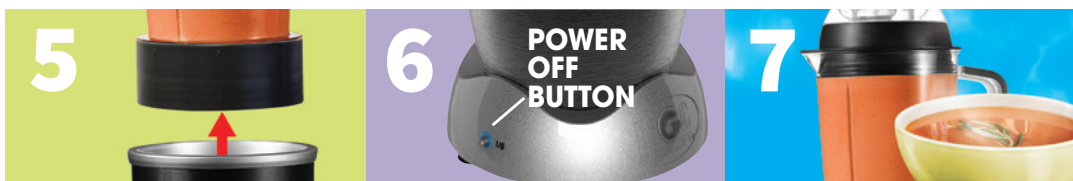

**5** **AFTER** the cycle completes and automatically shuts off the unit, carefully lift the soup pitcher off the **POWER BASE**.\*\* (**WARNING, INGREDIENTS WILL BE HOT**) **ALWAYS** use appropriate heat resistant pads to support the bottom of the pitcher and remove the pitcher from the **POWER BASE**.

**6** **DEPRESS** the power button, located 90° to the left side of the G-button, after each use, to turn off the **NUTRIBULLET Rx**. The **BLUE** light will stop glowing signifying the power is off.

**7** **REMOVE** the **SOUPERBLAST LID** carefully, using appropriate heat resistant pads as **SOUPERBLAST** will be hot and steam may escape!  
Pour your **SOUPERBLAST** into serving dishes and enjoy!\*\*\*

- \* To reduce the risk of injury, make sure blade is securely screwed onto pitcher before placing on Power Base. (**NEVER ATTEMPT TO PUT THE EXTRACTOR BLADE ON THE POWER BASE WITHOUT BEING SECURELY ASSEMBLED ONTO THE PITCHER FIRST**).
- \*\* Do not touch coupling gear directly with hands after SouperBlast mode! The coupling gear in blade base and Power base will be hot!
- \*\*\* After making a Nutriblast or Souperblast, the blade must be cleaned immediately.



**START WITH THIS DELICIOUS RECIPE**

## “CREAM” OF BROCCOLI : SERVES 4-6

- 1/3 cup sweet onion, chopped \*
- 1 small baking potato baked \*
- 2 bunches broccoli florets, steamed \*
- 2 cups plain, unsweetened almond milk
- 1/2 tsp Himalayan salt

**1** Steam broccoli and onion for about 5 min. Cook the potato either by baking, steaming, or roasting. Remove the skin.

**2** Allow all ingredients to cool fully. Once cool, add all ingredients to the SouperBlast Pitcher and extract on the 7-Minute Heated Cycle.

Fresh ground pepper to taste

\* COOLED TO ROOM TEMPERATURE FOR AT LEAST 30 MINUTES, IF MAKING IT FRESH!

**CAUTION:** THIS QUICK START GUIDE IS NOT INTENDED TO REPLACE THE USER GUIDE. FOR YOUR SAFETY, CAREFULLY READ ALL USER GUIDE INSTRUCTIONS BEFORE OPERATING YOUR NUTRIBULLET Rx.

## QUICK REFERENCE SAFE BLENDING GUIDE

**THESE SAFETY GUIDELINES ARE INTENDED FOR QUICK REFERENCE ONLY. CAREFULLY READ ALL INSTRUCTIONS IN YOUR USER MANUAL BEFORE OPERATING YOUR NUTRIBULLET®. SAVE THESE INSTRUCTIONS.**

### **GENERAL SAFETY**

**Close supervision is necessary when any appliance is used by or near children.** Keep cord out of reach of children.

Always operate the **NutriBullet®** on a level surface, leaving unobstructed space beneath and around the Power Base to permit proper air circulation. Slots on the bottom of the Power Base are provided for ventilation to ensure reliable operation and to prevent motor over-heating.

Periodically inspect all **NutriBullet®** components for damage or wear that may impair proper function or present an electrical hazard. Assure that the power cord and plug are undamaged. Discontinue use and replace Blending Containers if you detect cracking, crazing, cloudiness or damage to the plastic. Assure that the Blades rotate freely and that the gasket is seated and undamaged. Assure that Power Base switch actuators are unobstructed, clean, and depress easily. Follow maintenance instructions in User Manual and never operate your **NutriBullet®** with damaged components. If your **NutriBullet®** malfunctions in any way, immediately discontinue use and contact **NutriBullet Customer Service at (855) 346-8874**.

### **HEAT AND PRESSURE SAFETY**

**WARNING: TO AVOID PERSONAL INJURY, NEVER BLEND HOT INGREDIENTS OR LIQUID IN ANY CLOSED-TOP BLENDING CONTAINER OR PITCHER!! Heated ingredients can pressurize sealed containers when agitated and violently expel hot contents upon opening.**

Always start the blending process with room temperature or refrigerated ingredients and liquids (21°C/70°F or cooler).

**WARNING: Never Continuously Operate for Longer Than Necessary to Create a Smoothie — generally less than one-minute.** Blade friction from prolonged operation can heat ingredients and generate internal pressure in the sealed container. **If the Blending Container is warm to touch, allow to cool. Slowly unscrew the Blade Assembly from the Blending Container, pointed away from your face and body, to release any residual pressure.** Pressure can cause the blended contents to erupt from the Container, resulting in possible personal injury or property damage.

**WARNING: Never Blend Carbonated Liquids or Effervescent Ingredients (e.g., baking soda, baking powder, yeast, etc.).** Pressure from released gases can cause a sealed Blending Container to burst, resulting in possible injury or property damage.

Sugar in fruits and vegetables can ferment over time, releasing gases and causing pressure to build up in a sealed Blending Container. If you will not consume your smoothie immediately, remove the Blade, cover the Container with a lid or plastic wrap, and refrigerate. **Never store any blended mixture in a sealed Blending Container or for any prolonged period of time; contents will spoil and ferment.**

### **BLADE SAFETY**

**BLADES ARE SHARP! HANDLE CAREFULLY.** Use care when handling any Blade. To avoid laceration injury, do not handle or touch any Blade edge.

To Prevent Leakage and the Possible Separation of Components During Operation, properly align and securely attach (hand tighten) the Blade to a Blending Container, and check for leakage before placing it on the Power Base and operating your **NutriBullet®**.

**Never Store any Blade** in the Power Base unless attached to a Blending Container. An exposed blade can present a laceration hazard.

### **ELECTRICAL SAFETY**

**When using any electrical appliance, basic safety precautions should always be observed, including the following:**

**To avoid risk of electric shock, never immerse the Cord, Plug, or Power Base of blender in water or other electrical current conducting liquids. Discontinue use if the Cord, Plug, or Power Base is damaged.**

**Do not use this product in locations with different electrical specifications or plug types. Do not operate** with any type of plug adapter or voltage converter device, as these may cause electrical shorting, fire, electric shock, personal injury or product damage.

Your NutriBullet® has a **US/Canadian** configured polarized plug (one prong is wider than the other) to reduce the risk of electric shock. This plug will correctly fit in a polarized outlet only one way. If the plug does not fit fully in the outlet, reverse the plug. If it still does not fit, contact a qualified electrician. For your safety, do not modify the plug or Motor Base in any way.