

nutribullet®

PRO+



User guide.

Important safeguards.

WHEN USING ANY ELECTRICAL APPLIANCE, BASIC SAFETY PRECAUTIONS SHOULD ALWAYS BE OBSERVED, INCLUDING THE FOLLOWING:

Warning! To avoid the risk of serious injury, carefully read all instructions before operating your nutribullet®. When using any electrical appliance, basic safety precautions should always be observed, including the following important information.

! Save these instructions! ● FOR HOUSEHOLD USE ONLY

GENERAL SAFETY INFORMATION

- This appliance has sharp blades and moving parts, and is NOT intended for use by children or persons with reduced physical, sensory, or mental capabilities, or who lack experience and knowledge regarding its safe operation. Such persons require close supervision and thorough instruction on its proper use and safe operation. Close supervision is necessary when any appliance is used by or near children. Children should be supervised to ensure that they do not play with the appliance.
- Do not use outdoors.
- **NEVER LEAVE THE NUTRIBULLET® UNATTENDED WHILE IT IS IN USE.**

- **ALWAYS UNPLUG THE NUTRIBULLET® WHEN NOT IN USE.**

HEAT & PRESSURE SAFETY

To avoid personal injury, never blend hot or carbonated ingredients in any sealed nutribullet® Cup!

WARNING!

Heated ingredients can pressurize sealed containers when agitated and violently expel hot contents upon opening. Always start the blending process with room temperature or refrigerated ingredients and liquids (21°C/70°F or cooler).

Never continuously operate for longer than necessary to create your recipe — generally less than one minute.

WARNING: Never blend carbonated liquids or effervescing ingredients (e.g., baking soda, baking powder, yeast, etc.). Pressure from released gases can cause a sealed nutribullet® Cup to burst, resulting in possible injury and/or property damage. Blade friction from prolonged operation can heat ingredients and generate internal pressure in the sealed container. This pressure can cause the Cup and Extractor Blade to separate or blended contents to erupt from the container, resulting in possible personal injury and/or property damage. If the sealed nutribullet® Cups are warm to the touch, power off your machine and allow the vessel to cool for fifteen minutes or more. Allow contents to settle before slowly releasing the Cup from the Motor Base. With the nutribullet® Cup, pointed away from your face and body, slowly unscrew the Extractor Blade to gently release any residual pressure.

If the unit is permitted to run longer than one minute, friction from the rotating extractor blades can heat ingredients, causing internal pressure to build in the sealed cup. If the cup is warm

to touch, allow it to cool completely before carefully opening, pointed away from your body to avoid injury.

- After blending, allow the contents to settle. Release any pressure that may have built during the extraction process by slowly unscrewing the blade with the container pointed away from you.
- If you need to blend for longer than one minute, blend in 1-minute intervals. After the initial and each subsequent 1-minute blending cycles, allow the Motor Base to shut off completely and wait at least one minute before starting another cycle.
- Do not run for more than 3 consecutive 1-minute intervals to prevent the contents from overheating. Allow contents to settle for 2-3 minutes after the third extraction cycle to prevent overheating and buildup of pressure.
- **Do not allow blended mixtures to sit in a sealed container for long periods of time!** Sugar in fruits and vegetables can ferment over time, releasing gases and causing pressure to build up in a sealed nutribullet® Cup. If you will not consume your

smoothie immediately, remove the Extractor Blade, cover the container with a lid or plastic wrap, and refrigerate. Never store any blended mixture in a sealed nutribullet® cup, either unrefrigerated or for any prolonged period of time; contents will spoil and ferment.

EXTRACTOR BLADE SAFETY

Never store any Extractor Blade in the Motor Base unattached to a nutribullet® Cup. An exposed blade can present a laceration hazard.

WARNING: BLADES ARE SHARP! HANDLE CAREFULLY. Use care when handling any blade. To avoid laceration injury, do not handle or touch any blade edge.

AVOID CONTACT WITH MOVING PARTS! Keep hands and utensils out of and away from the Extractor Blade while blending food to reduce the risk of severe personal injury.

- To prevent leakage and the possible separation of components during operation, properly align and securely attach (hand-tighten) the Extractor Blade to a nutribullet® Cup, and check for leakage before placing it on the Motor Base and operating your nutribullet®.
- Once you have stopped your nutribullet®, wait until the

motor comes to a complete stop and the unit powers down completely before removing the Cup/Extractor Blade from the motor base. Taking the container off the unit prior to complete power down can cause damage to the Extractor Blade coupling or motor gear.

Never blend without liquid as doing so may damage the extractor blade or motor and impair blending performance.

- The cyclonic action® of your nutribullet® requires the use of liquids to make smoothies and other nutritious beverages. The nutribullet® is not intended to be used as an ice crusher or without liquids. Always add liquid to your smoothie.
- **DO NOT USE** the Extractor Blade for grinding dry ingredients such as grains, cereal, or coffee, as this may damage the motor and/or the Extractor Blade.
- The Extractor Blade will grow dull with usage. We recommend replacing your Extractor Blade every 6 months (depending on use) or as needed for optimal performance.
- Certain configurations may contain a milling blade. This blade can be used for milling herbs, spices, grains and seeds.

ELECTRICAL SAFETY

WARNING! Do not use this product in locations with different electrical specifications or plug types. Do not operate with any type of plug adapter or voltage converter device, as these may cause electrical shorting, fire, electric shock, personal injury or product damage. This appliance has important markings on the plug blade. The cord is not suitable for replacement. If damaged the appliance should be replaced.

POLARIZED PLUG INFORMATION:

- Your nutribullet® has a polarized plug (one prong is wider than the other) to reduce the risk of electric shock. This plug will correctly fit in a polarized outlet only one way. If the plug does not fit fully in the outlet, reverse the plug. If it still does not fit, contact a qualified electrician. For your safety, do not modify the plug or motor base in any way. Doing so will increase risk of injury and void the product's warranty.
- The use of third-party attachments, including canning jars, is forbidden and may cause fire, electric shock, personal injury, or product damage and will void the warranty.
- **To avoid risk of electric shock, never immerse the cord, plug,**

or Motor Base of blender in water or other electrical current conducting liquids. Discontinue use if the cord, plug, or Motor Base is damaged.

- Always **UNPLUG** the nutribullet® when it is not in use or **BEFORE** assembling, disassembling, changing accessories, or cleaning. Do not attempt to handle the nutribullet® until all parts have stopped moving.
- Switch off the appliance and disconnect from supply before changing accessories or handling moving parts.
- **CAUTION!** In order to avoid a hazard due to inadvertent resetting of the thermal cut-out, this appliance must not be supplied through an external switching device, such as a timer, or connected to a circuit that is regularly switched on and off by the utility.
- Periodically inspect all nutribullet® components for damage or wear that may impair proper function or present an electrical or mechanical hazard. Assure that power cord and plug are undamaged. Discontinue use and replace nutribullet® Cup if you detect cracking, crazing, cloudiness or damage to the plastic. Assure that the blades rotate freely

and that the gasket is seated and undamaged. Assure that Motor Base switch actuators are unobstructed, clean, and depress easily. Follow maintenance instructions in this User Guide on pages 14-15. Never operate your nutribullet® with damaged components. If your nutribullet® malfunctions in any way, immediately discontinue use and contact **nutribullet® Customer Service at 1 (800) 523-5993.**

- Do not allow the cord to hang over the edge of the table or counter. Do not pull, twist, or damage the power cord. Do not allow cord to touch hot surfaces, including the stove.
- If the motor stops working, unplug the Motor Base and let it cool for an hour before attempting to use it again. Your nutribullet® has an internal thermal breaker that shuts off the motor when it overheats. The thermal breaker will reset when the unit is unplugged and the thermal breaker cools down sufficiently.

VENTILATION

WARNING! To prevent a fire hazard, the openings on the bottom of the Motor Base should be free of dust or lint and never obstructed as they are provided for ventilation to ensure reliable motor

operation to prevent over heating. Never operate your nutribullet® on top of flammable materials such as newspapers, tablecloths, napkins, dish towels, place mats or other similar type of materials.

- **CAUTION!** Always operate the nutribullet® on a level surface, leaving unobstructed space beneath and around the motor base to permit proper air circulation. Slots on the bottom of the Motor Base are provided for ventilation to ensure reliable operation and to prevent the motor from overheating.

MICROWAVE & STOVE-TOP HEATING SAFETY

- **DO NOT BLEND HOT INGREDIENTS!** After blending room temperature or cooler ingredients (21°C/70°F or less), transfer mixture to an unsealed, microwave-safe container or to a stovetop pot to heat. Always use a thermometer to test the internal temperature of cooked ingredients. They may feel cool to the touch, but still be hot inside.
- Do not place any of the nutribullet® parts in a microwave, oven, or stovetop pot, or immerse in boiling water, as this may result in damage to the accessory.

- Avoid blending the following seeds and pits in the nutribullet®, as they contain a chemical known to release cyanide into the body when ingested: apple seeds, cherry pits, plum pits, peach pits, and apricot pits. Fruit pits may also cause damage to the blade and cup.

MEDICAL SAFETY

- The information contained in this User Guide is not meant to replace the advice of your physician. Always consult your physician regarding health and nutrition concerns.

MEDICATION INTERACTIONS:

- If you are taking any medication, especially cholesterol-lowering medication, blood thinners, blood pressure drugs, tranquilizers, or antidepressants, please check with your physician before trying any of the smoothie recipes contained in the Recipe Guide.

ADDITIONAL INSTRUCTIONS FOR PROPER USAGE

- **TO AVOID LEAKAGE, DO NOT OVERFILL THE CUP!** Make sure ingredients and liquid do not exceed the MAX line. The cyclonic action® of the nutribullet® requires space to extract effectively. Exceeding the MAX line can result in

leakage, and may create a dangerous pressurization which can cause the vessel and blade assembly to separate.

- Cup and Extractor Blades are specific to the exact model of nutribullet®. Use of incompatible parts (parts from other models) may result in damage to your nutribullet® or create safety hazards. When replacing Cups or an Extractor Blade or ordering additional accessories from nutribullet.com, or by contacting Customer Service, please specify the model for parts that are compatible with your unit.
- Periodically inspect all nutribullet® components for damage or wear that may impair proper function or present an electrical hazard. Make sure that the power cord and plug are undamaged. Discontinue use and replace blending vessels if you detect cracking, cloudiness, or other damage to the vessel, tabs on the vessel, or Actuator Tabs of the Motor Base. Ensure that the blades rotate freely and that the structure is undamaged. Make sure that the Motor Base is unobstructed and clean. Follow maintenance recommended on pages 13 and 14 and never operate

your nutribullet® with damaged components. If your nutribullet® malfunctions in any way, immediately discontinue use and contact Customer Service at 1 (800) 523-5993. You may purchase new nutribullet® Cups, and Extractor Blades at nutribullet.com or by contacting Customer Service. **We recommend replacing your cup every six months or as needed.**

! Save these instructions!

If you have any comments, questions, or concerns, please go to **nutribullet.com**. Or call Customer Service at: **1 (800) 523-5993.**

Contents.



- 10 What's included**
- 11 Assembly guide**
- 12 nutribullet® cup assembly & use**
- 16 Care & maintenance.**
 - 16 How to clean the nutribullet®
 - 17 Replacement parts
- 18 nutribullet®
one-year limited warranty**
- 21 Warranty registration**

Thank you for purchasing the nutribullet® Pro+.

What's included.

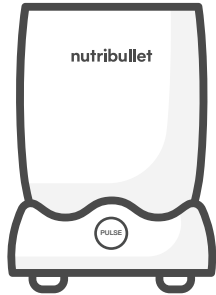

motor base



32oz cup

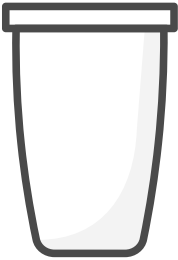

24oz cup



extractor blade



2 cup rings



2 to-go lids

Assembly guide.

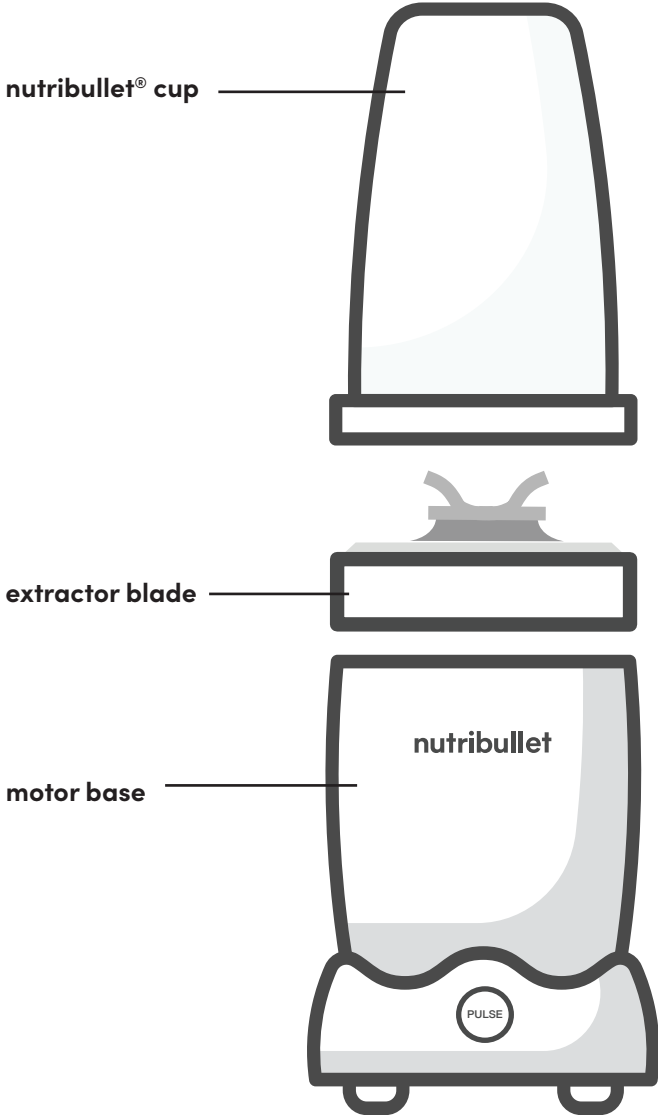

nutribullet® cup

extractor blade

motor base

Product configurations may vary. To see our full list of nutribullet® accessories please visit nutribullet.com

nutribullet® Pro+ cup assembly & use



PLEASE KEEP THESE IMPORTANT SAFEGUARDS IN MIND WHEN USING THE NUTRIBULLET®:

- Make sure the **Motor Base** is plugged in for use.
- Handle the **Extractor Blade** assembly with care, as the blades are sharp.
- Never run the nutribullet® while empty.
- nutribullet® accessories are not intended to be used in the microwave as it may damage the accessories.
- **Never** leave the nutribullet® unattended while in use.

Never blend hot ingredients when using any nutribullet® Cup.

WARNING: Heated ingredients can pressurize inside sealed containers when agitated and violently expel hot contents upon opening. Always start the blending process with room temperature or refrigerated ingredients and liquids (21°C/70°F or cooler).

BLEND MODE:

The default mode is **Blend** mode. When you plug in the **Motor Base**, you are in **Blend** mode.

When you rotate a **nutribullet® Cup** clockwise on the **Motor Base**, the safety interlock engages, the blue **LED** light illuminates, and **Blend** mode runs for 60 seconds. The unit stops and the **LED** light turns off.

- 1 Review all warning and caution statements in the Important Safeguards section (pg. 2-8) before proceeding to Step 2.



Place the **Motor Base** on a clean, dry, level surface such as a counter or table.



Add ingredients and liquid to the **nutribullet® Cup**.

NOTE: Do not overfill! To avoid leakage, do not add ingredients beyond the MAX line.

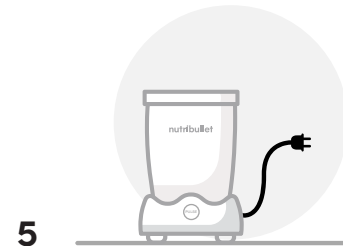

Plug the power cord into an electrical outlet.

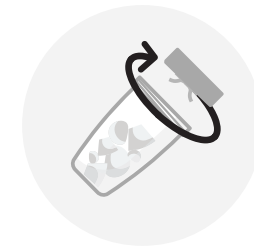

Place the **Extractor Blade** onto the **Cup** and twist until it is tightly sealed.

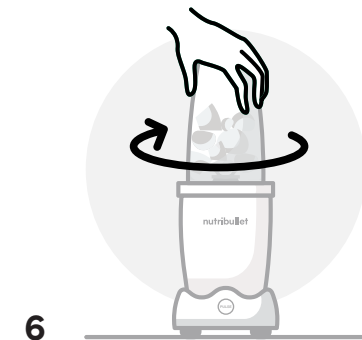

Turn the **Cup** upside-down and place it onto the **Motor Base**, gently push and twist.

Blend mode lasts for one minute.

NOTE: Blending should not require longer than one minute to yield smooth and creamy results.



7

Once **Blend** mode ends, unlock the assembly by gently pushing and untwisting the **Cup** counter-clockwise.

To manually stop **Blend** mode, simply twist the **Cup** counter-clockwise to disengage the safety interlock. Once the **Motor Base** and Blade stop completely, remove the **Cup** from the **Motor Base**.



CAUTION

Do not remove the **Extractor Blade** from the **nutribullet® Cup** until blending has completely ceased. Do not use the **Extractor Blade** as a storage lid for your **Cup**. Some foods may contain active ingredients or release gases that will expand if left in a sealed container, resulting in excessive pressure buildup that can pose a risk of injury. When storing contents in the **Cup**, use plastic wrap or foil to seal your container. Always point contents away from your body when unsealing.



3

The **Pulse** button will flash **BLUE** now that it's in **Pulse** mode.

NOTE: **Pulse** mode is active for 1 minute, and then it times out. If the **Cup** is still in the **ON** position, nothing will happen. The **Cup** must be rotated counter-clockwise to **OFF** position, and then normal function may be resumed.



4

Press and hold the **Pulse** button to make the **Extractor Blade** turn. Release the **Pulse** button to stop the blades. Let the **Extractor Blade** come to a complete stop after each **Pulse**. Press the button again until you reach your desired consistency.

PULSE MODE:

Because the **nutribullet®** motor is so powerful, it emulsifies the ingredients you extract. That is why when you want to make foods such as chunky salsa or coarse chopped onions, **Pulse** mode is key. Pulsing takes a tiny bit of getting used to, but once you get a feel for it, you'll be a pro in no time!

1 Follow steps 1-5 on pages 12-13.



2

Turn the **Cup** upside down and place it onto the **Motor Base**, gently push and twist. Then, quickly press the **Pulse** button, stopping the motor.



5

Unlock the assembly by gently pushing and untwisting the **Cup** counter-clockwise.



CAUTION

Do not remove the **Extractor Blade** from the **nutribullet® Cup** until blending has completely ceased. Do not use the **Extractor Blade** as a storage lid for your **Cup**. Some foods may contain active ingredients or release gases that will expand if left in a sealed container, resulting in excessive pressure buildup that can pose a risk of injury. When storing contents in the **Cup**, use plastic wrap or foil to seal your container. Always point contents away from your body when unsealing.

Care & maintenance.

Cleaning the nutribullet® is easy. Simply place any of the pieces (except for the Motor Base and Extractor Blade) on the **TOP RACK** of the dishwasher or hand-wash with warm soapy water and rinse.

Here's how to clean the nutribullet®:

STEP 1:

The most important thing — ALWAYS UNPLUG the Motor Base from the power supply outlet when it is left unattended, before assembling, disassembling, changing accessories or approaching parts that move in use or when cleaning. Do not attempt to handle the appliance until all parts have stopped moving!

STEP 2:

Remove the Cup/Extractor Blade assembly from the Motor Base.

STEP 3:

Clean the individual components (Motor Base, Extractor Blades, nutribullet® Cups) as follows:

MOTOR BASE:

- For the most part, the Motor Base doesn't really get dirty, but if you neglect to twist the Extractor Blade on to the Cup tightly, liquids can leak out and get into the base and stick to the activator buttons.
- To avoid risk of injury, **NEVER** use your hands or utensils to clean the white Actuator Tabs while the nutribullet® is plugged in.
- Do not remove the rubber or plastic liners inside the Motor Base.
- Use a sponge or dish cloth dampened with warm soapy water to wipe down the inside and outside of the Motor Base until clean.
- Pay particular attention to the white Actuator Tabs on the inner rim of the Motor Base to loosen any sticky debris from drips and spills. If necessary, you may use a small brush to scrub the area to ensure it is kept clean.

 **WARNING:** Never submerge the Motor Base in water or other liquids.

EXTRACTOR BLADE:

- **DO NOT REMOVE THE GASKET** as this will permanently damage the Extractor Blade and cause leakage. If after washing as indicated above, additional cleaning is desired, you may rinse with a 10% vinegar/water solution or with lemon juice. If, over time, the gasket becomes loose or damaged, you may order a new Extractor Blade at nutribullet.com or contact Customer Service.
- Dry the Extractor Blade completely. It is helpful to turn the blade on its side in your dish drainer to ensure **BOTH SIDES** of the Extractor Blade are completely dried.

NUTRIBULLET® CUPS & TO-GO LIDS (included with some configurations):

- These items are all **TOP RACK** dishwasher safe. We recommend rinsing them and giving them a quick brush with a dish brush to remove any dried debris before washing them in the dishwasher. **NEVER** use the sanitize cycle to wash the Cups as this may warp the plastic.
- Regularly check the 3 tabs on the side of the Cup for cracking, crazing, breakage or rounding. If damaged,

replace immediately to prevent possible personal injury.

- **NEVER USE A CUP WITH A BROKEN, DAMAGED, OR MISSING TAB, AS DOING SO MAY CAUSE THE CUP AND MOTOR BASE TO SEPARATE EXPOSING THE BLADE ASSEMBLY!**

STUBBORN CLEAN UP:

- If ingredients dry inside the nutribullet® Cup, make your cleanup a snap by filling the cup about 2/3 full with room temperature (21°C/70°F or less) water and twisting on the Extractor Blade. Place the Cup/Extractor Blade assembly on the nutribullet® Motor Base for about 20-30 seconds. This will loosen the stuck-on ingredients.

Replacement parts.

To order additional parts and accessories, please visit our website at nutribullet.com/shop/accessories or feel free to contact Customer Service: **1 (800) 523-5993.**

nutribullet® Pro+ one-year limited warranty.

LIMITED WARRANTY FOR NUTRIBULLET®

nutribullet's limited warranty obligations are confined to the terms set forth below:

nutribullet, LLC and Capital Brands Distribution, LLC (together, "nutribullet") warrants this nutribullet® against defects in materials and workmanship for a period of one year from the date of original retail purchase. This limited warranty is valid only in the country in which the product is purchased and comes with the product at no extra charge, however shipping and processing fees will be incurred for returns, replacements and/or refunds.

If a defect exists, and this limited warranty is valid, at its option nutribullet® will (1) repair the product at no charge, using new or refurbished replacement parts, (2) exchange the product with a product that is new or that has been manufactured from new or serviceable used

parts and is at least functionally equivalent to the original product, or (3) refund the purchase price of the product. A replacement product assumes the remaining warranty of the original product. A repaired product has a one-year warranty from the date of repair. When a product or part is exchanged, any replacement item becomes your property and the replaced item becomes nutribullet's property. When a refund is given, your product becomes nutribullet's property.

OBTAINING WARRANTY SERVICE

For limited warranty service, simply call our Customer Service Department at 1 (800) 523-5993 or contact us via email from our website at nutribullet.com, simply click the contact us link, fill out and submit the customer contact form and we will be glad to help you. When you contact our Customer Service Department you will be asked for your name, address, telephone number

and to provide proof of the original purchase (receipt) containing a description of the product(s), purchase date, and the appropriate nutribullet® serial number(s). Before you send your product for limited warranty service please make sure to keep a copy of all relevant documents for your files (receipt, etc.). It is always recommended to purchase product insurance and tracking services when sending your product for service. Remember, shipping and processing fees will be incurred by you and are not covered by the one-year limited warranty.

EXCLUSIONS & LIMITATIONS

This nutribullet® One-Year Limited Warranty applies only to nutribullet® products distributed by or for nutribullet® that can be identified by the "nutribullet" trademark, trade name, logo and bar code. nutribullet's One-Year Limited Warranty does not apply to any inauthentic products not distributed/sold by nutribullet, LLC.

Normal wear and tear is not covered by this limited warranty. This limited warranty applies to household use only, and is

void when the product is used in a commercial or institutional setting.

This limited warranty extends only to the original consumer purchaser and is not transferable. In addition, proof of purchase must be demonstrated.

Repair or replacement of the product (or, if repair or replacement is not feasible, a refund of the purchase price) is the exclusive remedy of the consumer under this limited warranty. nutribullet, LLC shall not be liable for any incidental or consequential damages for breach of this limited warranty or any implied warranty on this product.

This limited warranty gives you specific legal rights, and you may also have other rights which vary from state to state. nutribullet® is not liable for any damage to products not covered by this warranty (e.g., cups, book, User Guide).

This limited warranty does not apply: (a) to damage caused

by accident, abuse, misuse, or misapplication; (b) to damage caused by improper maintenance (including unauthorized parts service); (c) to a product or a part that has been modified in any way; (d) if any nutribullet® serial number or trademark has been removed or defaced; (e) commercial or institutional usage; and/or (f) if the product has been used with an adapter/converter.

THIS LIMITED WARRANTY AND THE REMEDIES SET FORTH ABOVE ARE EXCLUSIVE AND IN LIEU OF ALL OTHER WARRANTIES, REMEDIES AND CONDITIONS, WHETHER ORAL OR WRITTEN, EXPRESS OR IMPLIED. NUTRIBULLET® SPECIFICALLY DISCLAIMS ANY AND ALL IMPLIED WARRANTIES, INCLUDING, WITHOUT LIMITATION, WARRANTIES OF MERCHANTABILITY AND FITNESS FOR A PARTICULAR PURPOSE. IF NUTRIBULLET® CANNOT LAWFULLY DISCLAIM IMPLIED WARRANTIES UNDER THIS LIMITED WARRANTY, ALL SUCH WARRANTIES, INCLUDING WARRANTIES OF MERCHANTABILITY AND FITNESS FOR A PARTICULAR

PURPOSE ARE LIMITED IN DURATION TO THE DURATION OF THIS LIMITED WARRANTY.

No nutribullet® reseller, agent, or employee is authorized to make any modification to this warranty.

NUTRIBULLET® IS NOT RESPONSIBLE FOR DIRECT, SPECIAL, INCIDENTAL OR CONSEQUENTIAL DAMAGES RESULTING FROM ANY BREACH OF WARRANTY OR CONDITION, OR UNDER ANY OTHER LEGAL THEORY, INCLUDING BUT NOT LIMITED TO LOST PROFITS, DOWNTIME, GOODWILL, DAMAGE TO OR REPLACEMENT OF EQUIPMENT AND PROPERTY. NUTRIBULLET® SPECIFICALLY DOES NOT REPRESENT THAT IT WILL BE ABLE TO REPAIR ANY PRODUCT UNDER THIS LIMITED WARRANTY.

Some states and provinces do not allow the exclusion or limitation of incidental or consequential damages or exclusions or limitations on the duration of implied warranties or conditions, so the above limitations or exclusions may not apply to you. This warranty gives you specific legal rights, and you may also have other rights that vary by state or province.

Warranty registration.

Please visit nutribullet.com/warranty-registration or call **1 (800) 523-5993** to register your new nutribullet®. You will be asked to enter the **Serial Number*** of your product, along with the purchase date and place of purchase.

The registration will enable us to contact you in the unlikely event of product safety notification. By registering your product you acknowledge to have read and understood the instructions for use, and warnings set forth in the accompanying instructions.



How to find serial number under the Motor Base.

Capital Brands Distribution, LLC | nutribullet.com | All rights reserved.

nutribullet® and the nutribullet® logo are trademarks of CapBran Holdings, LLC registered in the U.S.A. and worldwide.

Illustrations may differ from the actual product. We are constantly striving to improve our products, therefore the specifications contained herein are subject to change without notice.

221228_N12-1001MK