

# magic bullet.<sup>®</sup>

*blender*



***user* guide.**

# important safeguards.

When operating your magic bullet® Blender, remember: **safety comes first. When using any electrical appliance, basic safety precautions should always be observed, including the following:**

 **warning!** To avoid the risk of serious injury, death, property damage, or damage to your device, carefully read all instructions in this User Guide before operating your magic bullet® Blender.

If you let anyone else use your magic bullet®, make sure that they understand the health and safety information in this User Guide, as well as any additional safety or usage instructions provided. Each person using a device should read the User Guide in its entirety to become familiar with the safe operation of the unit.

## Save these instructions! *for household use only*

**READ ALL INSTRUCTIONS CAREFULLY AND THOROUGHLY BEFORE OPERATING.**

### **general use and safety:**



Failure to follow all instructions regarding the use of your magic bullet® Blender may result in serious personal injury, death, or property damage. Be aware of possible hazards when using or storing your magic bullet® Blender.

 **warning!** **EXTREME CAUTION SHOULD BE EXERCISED WHEN USING HOT, WARM, OR CARBONATED INGREDIENTS IN THE PITCHER. ALWAYS MAKE SURE THE VENTED PITCHER LID IS SECURED ONTO THE PITCHER BEFORE OPERATING THE BLENDER WITH THE PITCHER ATTACHED.**

 **warning!** **NEVER BLEND HOT, WARM, OR CARBONATED INGREDIENTS IN THE BLENDING CUP! FRICTION FROM THE ROTATING BLADES CAN CAUSE CONTENTS TO HEAT AND PRESSURIZE, WHICH MAY CAUSE THE CUP TO SEPARATE UPON OPENING OR REMOVAL**

**FROM THE MOTOR BASE  
EXPPELLING HOT CONTENTS AND  
/OR EXPOSING THE BLADE  
RESULTING IN SERIOUS BODILY  
INJURIES OR PROPERTY DAMAGE.**

- Do not use the magic bullet® Blender for other than its intended purpose.
- Always make sure that all non-food items (e.g., spoon or fork) are removed before blending. Non-food items left in the pitcher may crack or shatter the attachment resulting in bodily injury or damage.
- Close supervision is necessary when any appliance is used by or near children to ensure they do not play with the appliance. Keep cord out of reach of children.
- This appliance is not intended for use by persons (including children) with reduced physical, sensory, or mental capabilities, or lack of experience and knowledge, unless they are closely supervised and instructed concerning use of the appliance by a person responsible for their safety.

- **NEVER LEAVE THE MAGIC BULLET® BLENDER UNATTENDED WHILE IT IS IN USE.**
  - Do not place or operate your magic bullet® Blender on uneven or unstable surfaces.
  - The risk of fire, shock or damage to magic bullet® Blender during cleaning can be reduced by taking the following precautions:
    - Unplug and turn your device off before cleaning.
    - Only clean the exterior of your device.
    - Clean your device with a dry cloth.
  - Do not attempt to clean the Motor Base by immersing it in water or other cleaning liquids. Only gently wipe and dry the Motor Base with a clean cloth.
  - Do not place any magic bullet® part or accessory in a microwave, conventional oven, air fryer, or stovetop pot, or immerse in boiling water, as this will damage the part.
  - Do not place or operate your magic bullet® Blender on or near a hot gas or electric burner, or in a heated oven.
  - **NEVER** wash your magic bullet® parts or accessories using the sanitize or heat cycle of your dishwasher. Doing so can warp the part, which can create hazardous conditions during use that may result in bodily injury or property damage.
  - **NEVER** place any magic bullet® parts or accessories in the freezer or use as a storage container in the freezer.
  - Make sure your magic bullet® Blender is powered off, unplugged, and the motor and blades are completely stopped before removing or cleaning the unit.
  - Remove and safely discard any packaging material or promotional labels before using the appliance for the first time.
  - Do not operate if any of the parts and accessories are damaged in any manner which may impair proper function or create a safety hazard. Contact Customer Service for assistance at: **1 (800) 523-5993.**
  - Do not use parts or accessories from other manufacturers or different models of magic bullet® products. Use of parts and accessories **NOT** provided by magic bullet® may damage your unit or cause serious injury.
  - Use only genuine magic bullet® attachments/accessories specifically designed for your magic bullet® Blender. Aftermarket parts are not made to magic bullet® specifications and may damage your unit or cause serious injury.
  - Do not attempt to defeat any safety interlock mechanisms.
  - **DO NOT USE OUTDOORS.**
  - **ALWAYS UNPLUG THE MAGIC BULLET® BLENDER WHEN NOT IN USE.**
- using the blending pitcher:**
-  **warning!** BEFORE STARTING A BLENDING CYCLE, ALWAYS AFFIX THE VENTED PITCHER LID TO THE BLENDING PITCHER WITH THE CAP TWISTED CLOSED. THIS WILL PREVENT INGREDIENTS FROM SPLASHING AND HOT INGREDIENTS FROM SPLATTERING, WHICH MAY CAUSE BURNS, BODILY INJURIES, OR PROPERTY DAMAGE.
- After blending hot ingredients or liquids, exercise caution when opening the Pitcher Lid; hot steam may escape, or hot ingredients may splatter.
  - Do not overfill the Blending Pitcher beyond the MAX line.
-  **warning!** PRESSURIZED STEAM RELEASED FROM HOT LIQUIDS DURING BLENDING CAN CAUSE THE LID TO ERUPT FROM THE BLENDING PITCHER. TO PREVENT POSSIBLE BURN INJURIES, DO NOT FILL THE PITCHER BEYOND THE MAX LINE.
-  **warning!** TO INCORPORATE INGREDIENTS DURING BLENDING, OPEN THE VENTED CAP AND CAREFULLY POUR OR DROP INGREDIENTS INTO THE MIXTURE.



**warning!** ALWAYS USE CAUTION WHEN OPENING THE VENTED CAP IF THE BLENDED MIXTURE IS HOT OR WARM, AND BE MINDFUL OF ESCAPING STEAM OR THE SPLATTERING OF HOT INGREDIENTS. ALWAYS SECURELY REATTACH THE VENTED LID CAP AFTER ADDING INGREDIENTS.

- When using manual speeds, always start blending on the **LOW** setting to integrate ingredients, then increase speed as needed.

### **blending pitcher safety:**

Proper use of the Blending Pitcher is important for the safe operation of your magic bullet® Blender. Using the Blending Pitcher inconsistent with these instructions may result in bodily injury, property damage, or damage to your unit.

- Always operate the Blending Pitcher with the Pitcher Lid securely locked into place.
- Before blending, check that the vent slots on the Pitcher Lid are clear and unobstructed. Clogged or obstructed vent slots can pressurize contents, potentially expelling the Lid from the Blending Pitcher, which can result in personal injury and property damage from escaping steam or hot ingredients.
- For recipes that require certain ingredients to be incorporated during blending, first add the base ingredients, then attach the Pitcher Lid and begin blending. Once the ingredients are well mixed, twist open the Vented Lid Cap and carefully pour or drop ingredients into the blended mixture. If the blended mixture is hot or warm, use caution and open the Vented Lid Cap slowly, being mindful of escaping steam or the splattering of hot ingredients. Always securely reattach the Vented Lid Cap when you are finished adding ingredients.

- Do not place hands or utensils inside the Blending Pitcher. This can result in severe bodily injury or damage.
- **NEVER USE** spatulas, spoons, or other tools that may make contact with the spinning blade during use. Doing so can damage the unit, shatter the Blending Pitcher, and cause severe bodily injury or property damage.

### **general blade safety:**



**warning!** BLADES ARE SHARP! HANDLE WITH CARE TO AVOID BODILY INJURY. NON-FOOD ITEMS OR HARD INGREDIENTS MAY DAMAGE THE BLADES OF YOUR MAGIC BULLET® BLENDER. ROUTINELY INSPECT THE BLADES AND DISCONTINUE USE IF DAMAGED. OPERATING THE BLENDER WITH DAMAGED BLADES OR IN ANY MANNER INCONSISTENT WITH THESE INSTRUCTIONS MAY RESULT IN BODILY INJURY, PROPERTY DAMAGE, OR DAMAGE TO YOUR UNIT. DO NOT TOUCH THE SHARP EDGES OF THE BLADES. TO AVOID LACERATION INJURY, DO NOT HANDLE OR TOUCH ANY SHARP COMPONENTS OF THE BLADE.

**NEVER STORE EXPOSED BLADES ON THE MOTOR BASE. EXPOSED BLADES CAN PRESENT THE HAZARD OF LACERATION AND SEVERE PERSONAL INJURY. ALWAYS ATTACH BLADE TO THE BLENDING PITCHER WHEN STORING.**

- Do not remove the Blending Pitcher until blades have come to a complete stop. Removing before the blades come to a complete stop can cause damage to the attachments or unit.
- Always **POWER OFF** and **UNPLUG** the unit and wait until the Blade comes to a complete stop before assembling, disassembling, changing accessories, or cleaning.

- **ALWAYS** securely tighten the Cross Blade to the Blending Pitcher to prevent leakage.
- **DO NOT** attempt to disengage the Blending Pitcher from the Motor Base if it starts to leak during blending. If a leak occurs, power off or unplug the unit and allow the motor to come to a complete stop before removing the Blending Pitcher. This will prevent risk of separation of and exposure to the spinning blade.
- **DO NOT** crush ice. Your magic bullet® Blender is not intended to be used as an ice crusher, which may shatter the Blending Pitcher, causing injury or damage.
- **DO NOT** blend stone fruit in this appliance unless pits/seeds have been removed. Fruit pits may damage the Blending Pitcher, potentially resulting in shattering and personal injury. In addition, apple seeds and the pits of cherries, plums, peaches, and apricots contain a chemical known to release cyanide into the body when ingested.
- Do not overload the Blending Pitcher as this may prevent the Blade from spinning. If this occurs, turn off the unit, empty some of the contents, reattach, and resume.
- Do not attempt to grind dry ingredients such as grains, cereal, or coffee, as this may damage the motor and/or Blade. Use of dry ingredients may cause the motor to overheat.
- **AVOID CONTACT WITH MOVING PARTS!** Keep hands and utensils out of and away from the Blade to reduce the risk of severe personal injury or damage to the unit.
- **NEVER** place the Blade or any magic bullet® part or accessory on the bottom rack of the dishwasher or use the heat/sanitize cycle.
- Periodically inspect your Cross Blade. If the blades do not rotate freely or are damaged, immediately discontinue use and contact Customer Service. If the gasket

to the Blade is missing or damaged, discontinue use and contact Customer Service. We recommend replacing the Blade every 6 months (depending on use), or as needed for optimal performance.

- Do not use after-market replacement parts for your magic bullet® Blender. After-market replacement parts may result in damage to your magic bullet® Blender or create safety hazards resulting in bodily injury or damage. Only order replacement parts from **getmagicbullet.com** or by contacting customer service at **1 (800) 523-5993**. When calling, please specify the product model to order compatible parts.

### ***electrical safety:***

Modification, improper use, and failure to follow the instructions for proper set up, use, and care of your magic bullet® Blender can increase the risk of serious personal injury, death, or property damage.

- Do not use the unit in countries or locations with different electrical specifications or plug types.
- Do not use the unit with a voltage converter device, as it may cause electrical shorting, fire, or electric shock, resulting in personal injury or damage to the product or property.
- Do not use the unit in an area that is wet, or anywhere it could become wet.
- This appliance has a polarized plug (one blade is wider than the other). To reduce the risk of electric shock, this plug will fit in a polarized outlet only one way. If the plug does not fit fully in the outlet, reverse the plug. If it still does not fit, contact a qualified electrician. Do not modify the plug in any way.
- Do not attempt to plug the unit into an electrical outlet with wet hands.

- Do not use the cord, plug, or Motor Base if it has been immersed in water or other liquids. Any significant spillage on, under, or around the Motor Base should be cleaned and dried before plugging in and using the unit.
- Do not modify the electrical cord in any way.
- Do not operate any unit with a damaged electrical cord or plug. The electrical cord and plug are not suitable for replacement. If damaged, the appliance must be replaced. Contact Customer Service for assistance at: **1 (800) 523-5993**.
- Do not allow or place the electrical cord near or touching any hot surfaces, heat source, or flame, including the stove.
- Do not allow the electrical cord to hang over the edge of a table or counter.
- Do not pull, twist, or damage the power cord.
- Overloading the unit may overheat the motor and engage the thermal breaker. If the internal thermal breaker shuts off the motor, unplug the Motor Base and let it cool for an hour before attempting to use it again. The thermal breaker will reset when the unit is unplugged and the thermal breaker cools down.
- Always **UNPLUG** your magic bullet® Blender when it is not in use, and when assembling, disassembling, changing accessories, or cleaning.
- **NEVER** pull from the power cord to unplug. To unplug, grasp the plug and pull from the outlet.
- Use of incompatible parts or aftermarket parts may result in damage to your magic bullet® Blender or create safety hazards that may cause personal injury or damage. When ordering replacement parts, always use genuine magic bullet® parts and accessories from [getmagicbullet.com](http://getmagicbullet.com) or contact Customer Service at: **1 (800) 523-5993**.

### **ventilation:**

- **NEVER** obstruct the ventilation openings on the bottom of the Motor Base of your magic bullet® Blender. Openings on the bottom of the Motor Base should be free of dust and lint and never obstructed. Obstructing the ventilation openings may overheat the motor, presenting a fire hazard that may cause serious personal injury, death, or property damage.
- **ALWAYS** operate the magic bullet® Blender on a level surface, leaving unobstructed space beneath and around the Motor Base to permit proper air circulation. Slots on the bottom of the Motor Base are provided for ventilation to ensure reliable operation and to prevent the motor from overheating.
- **NEVER** place your magic bullet® Blender on top of flammable materials such as newspapers, tablecloths, napkins, dishtowels, place mats, or other similar materials.

### **medical safety:**

- Always consult your physician regarding health and nutrition concerns and advice. The information contained in this User Guide, accompanied Recipe Guide, and/or online recipes are general suggestions and ideas, and are not meant to replace the advice of your physician.

### **medical interactions:**

- If you are taking any medications, especially cholesterol-lowering medication, blood thinners, blood pressure drugs, tranquilizers, or antidepressants, please check with your physician before trying any of the recipes contained in the Recipe Guide or published online.

- **ALWAYS** follow recommended maintenance and care instructions in the User Guide. **NEVER** operate your magic bullet® Blender with damaged components. If your magic bullet® Blender malfunctions or is damaged in any way, immediately discontinue use and contact Customer Service at: **1 (800) 523-5993**. If you have any comments, questions, or concerns, please go to [getmagicbullet.com](http://getmagicbullet.com) or call Customer Service.

**! Save these  
● instructions!**





# **contents.**

- 10** what's included
- 11** assembly guide
- 12** user interface
- 13** using the blender pitcher
- 16** maintaining the magic bullet® Blender
- 19** magic bullet® Blender  
one-year limited warranty
- 22** product registration

**thank you** for purchasing the magic bullet® Blender.

# what's *included*.

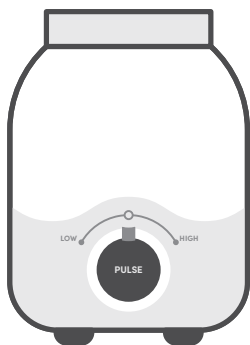

**motor base**

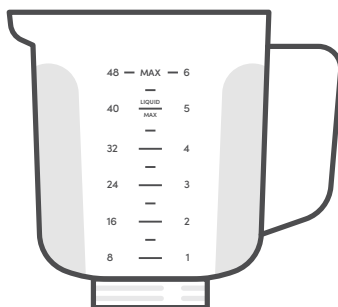

**pitcher**



**cross blade**

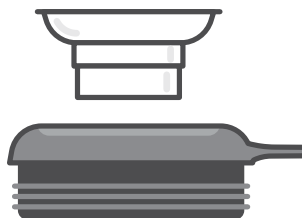

**pitcher lid**

Product configurations may vary. To see our full list of magic bullet® accessories please visit [getmagicbullet.com](http://getmagicbullet.com)

# ***assembly* guide.**

removable  
lid cap



pitcher lid



pitcher

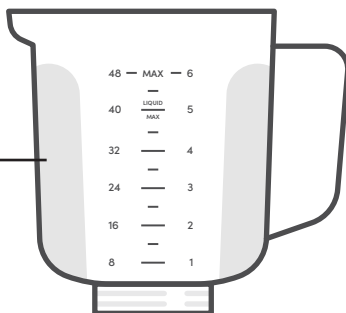

cross blade



motor base

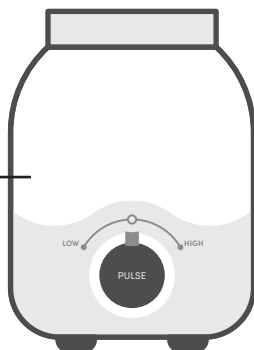

# user *interface.*

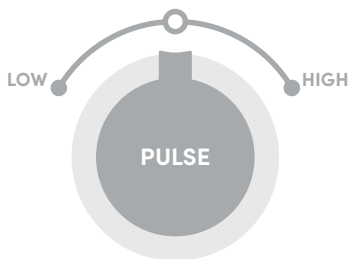

## home

The dial is in the center position. The blender is not running.

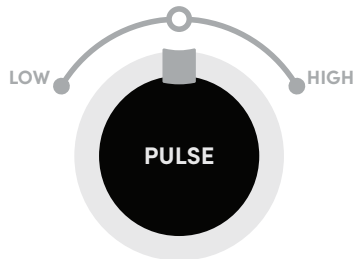

## pulse

With the dial in the center position, press and hold the **PULSE** button. To stop blending, release the **PULSE** button.

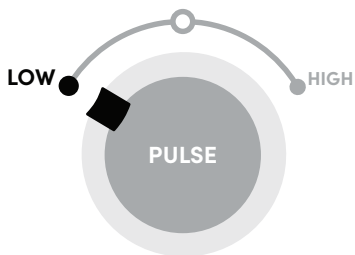

## low

Turn the dial to the left to start a preset 1 minute low-speed blend cycle. Turn the dial back to **HOME** when finished.

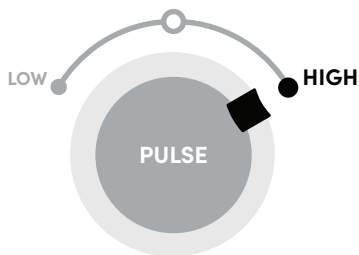

## high

Turn the dial to the right to start a preset 1 minute high-speed blend cycle. Turn the dial back to **HOME** when finished.



**warning!** NEVER blend hot, warm, or carbonated ingredients in the magic bullet® Cup! When using a Cup attachment, after two consecutive blends cycles wait 10 minutes before blending another cycle. Never attempt to open the Cup if it is warm to the touch, allow the Cup and its content to cool at least 15 minutes before attempting to open.

# using the blender pitcher.

## **warning!**

Only operate the **Blending Pitcher** with the **Pitcher Lid** securely attached.

Never turn the power on while using the **Pitcher** without the **Vented Lid Cap** inserted and locked into place!

Always use extreme care and attention when blending hot ingredients!

Always use caution when opening the **Pitcher Lid** after blending hot ingredients!

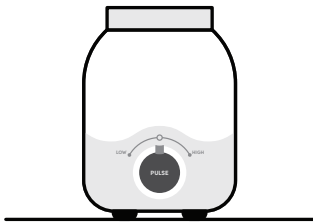

- 1** Place the **Motor Base** on a clean, dry, level surface.

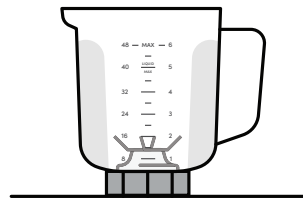

- 2** Inspect the **Pitcher** and ensure the **Pitcher** and **Blade** are secured. To tighten the **Blade**, twist it counter-clockwise onto the bottom of the **Pitcher**. To loosen/release the **Blade**, twist it clockwise until it detaches from the **Pitcher**.

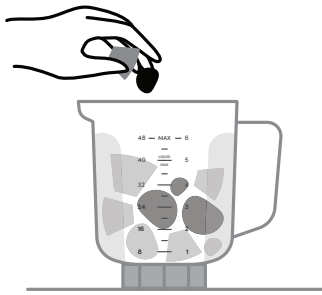

- 3** Add ingredients to the **Pitcher**.

 **warning!** DO NOT exceed the **MAX** line!

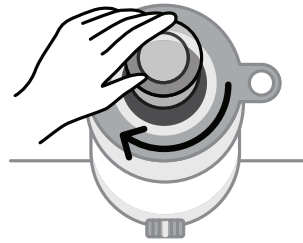

- 4** Place the **Lid** on top of the **Pitcher** and press down firmly to snap into place. Place the **Lid Cap** over the **Lid** opening, then press down and twist to lock it in place.

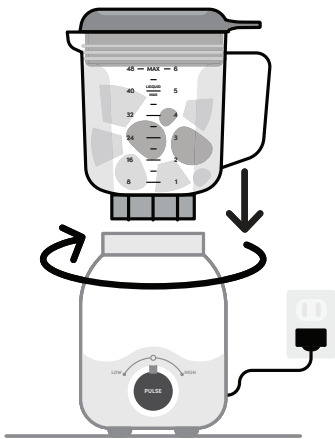

- 5** Place the **Pitcher** upright onto the **Motor Base** so the **Blade** meets the **Motor Base** and gently twist it clockwise to lock into place. You will feel a “click” when the blender is secured.

Plug the power cord into an outlet.



- 6** Run the desired blending program: twist the **Power Control Knob** to **LOW** or **HIGH** or keep in the **HOME** position and press the dial button to **PULSE**.

If the blender won't run, double check to ensure the **Pitcher** is locked in place.



- 7** If using the **HIGH** or **LOW** blending cycle, return the **Power Control Knob** to the **HOME** position after the 1 minute cycle completes. If ingredients require further blending, return the **Power Control Knob** to the **HOME** position first before beginning the next cycle of blending (**HIGH**, **LOW**, or **PULSE**).



- 8** Twist the **Knob** to **HOME** once you have finished blending.

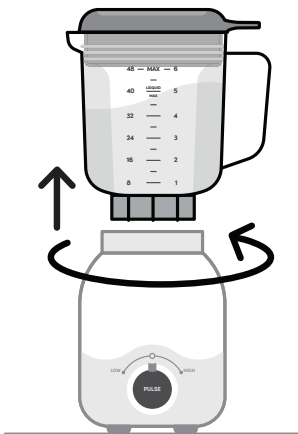

- 9** Twist the **Pitcher** counterclockwise and lift off of the **Motor Base**.



- 10** Lift the lid tab with your thumb to loosen and remove the **Lid**. Transfer contents to your desired serving vessel and enjoy!

 **warning!** Blades are sharp. Never insert your hands into the **Pitcher**.

# *maintaining the* magic bullet® Blender.

Cleaning the magic bullet® Blender is easy. All components, except the **Motor Base**, are dishwasher safe.

## **warning!**

Blades are sharp! Handle with care.

Never submerge the **Motor Base**! Keep it away from water and other liquids.



**1** **POWER OFF** and **UNPLUG** the **Motor Base**.

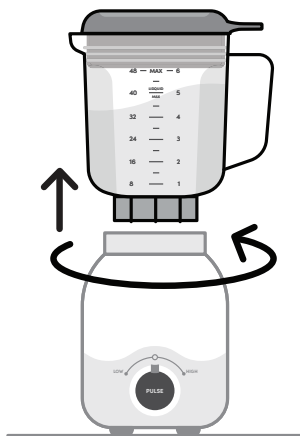

**2** Separate the **Pitcher** from the **Motor Base**.





- 3** Lift the lid tab with your thumb to loosen and remove the **Lid**.

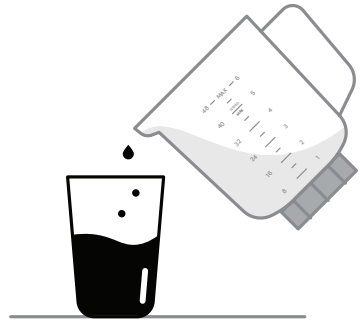

- 4** Remove / transfer any remaining ingredients from the **Pitcher**.

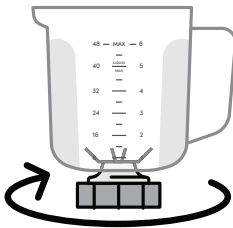

- 5** Twist the **Blade** clockwise to remove it from the **Pitcher**.



- 6** You can hand-wash the **Pitcher** or any other accessories. You can also place them onto the top rack of the dishwasher.



**warning!** NEVER use the sanitize cycle for risk of warping the accessories.

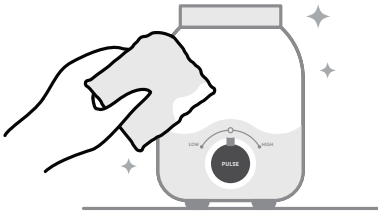

- 7** You can clean the **Motor Base** by wiping the surface with a damp sponge or cloth.

**!** **warning!** NEVER submerge the **Motor Base** in any liquid OR remove pieces from the **Motor Base**.

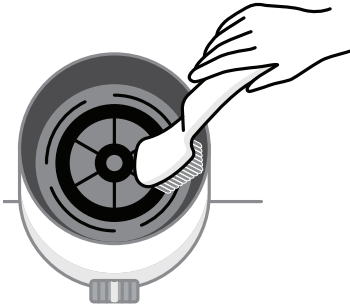

- 8** You can scrub the actuator clean with a small, dry brush.

**!** **warning!** NEVER try to clean the **Motor Base** while it is plugged in.

## storing your blender.

Store all components of the unit together in a safe place where they will not be damaged or cause harm. Never leave the blades exposed during storing.

## replacement parts.

Order new and replacement parts at [getmagicbullet.com](http://getmagicbullet.com) or call customer service at 1 (800) 523-5993.

Use only genuine magic bullet® parts and accessories specifically designed for your magic bullet® Blender. Aftermarket parts are not made to magic bullet® specifications and may damage your unit or cause serious bodily injury or damage.

# magic bullet®

## Blender one-year *limited warranty.*

### limited warranty for magic bullet® Blender:

**The magic bullet® limited warranty obligations are confined to the terms set forth below:**

Capital Brands Distribution, LLC and magic bullet , LLC, (together herein “Capital Brands”) warrants this magic bullet® Blender against defects in materials and workmanship for a period of one year from the date of delivery of the product to the consumer. This limited warranty is valid only in the country in which the product is purchased and comes with the product at no extra charge. However, shipping and processing fees for returns, replacements, and/or refunds will be incurred.

If a defect exists, and Capital Brands is obligated under this limited warranty, at its option, Capital Brands will either (1) repair the product at no charge, using new or refurbished replacement parts, (2) exchange the product with a product that is new or that has been remanufactured or refurbished from new or serviceable used parts and is at least functionally equivalent to the original product, or (3) refund the purchase price of the product. A replacement product assumes the remaining warranty of the original product. A repaired product has a one-year warranty from the date

of repair. When a product or part is exchanged, any replacement item becomes your property, and the replaced item becomes Capital Brands’ property. When a refund is given, your product becomes Capital Brands’ property.

### **OBTAINING WARRANTY SERVICE**

For limited warranty service, call our customer service department at **1 (800) 523-5993** or contact us via email from our website at **getmagicbullet.com** click the Contact Us link, fill out and submit the customer contact form, and we will be glad to help you. When you contact our Customer Service Department, you will be asked to provide your name, address, telephone number, and proof of the original purchase (receipt) containing a description of the product(s), purchase date, deliver receipt of product, and the appropriate magic bullet® bar code(s). Before sending your product for limited warranty service, please make sure to keep a copy of all relevant documents for your files (receipt, etc.). It is always recommended to purchase product insurance and tracking services when sending your product for service. Remember, shipping and processing fees will be incurred and are not covered by the one-year limited warranty.

### **EXCLUSIONS & LIMITATIONS**

This magic bullet® Blender One-Year Limited Warranty applies only to magic bullet® Blender products distributed

by or for Capital Brands that can be identified by the magic bullet® Blender trademark, trade name, logo, and bar code. The magic bullet® Blender's One-Year Limited Warranty does not apply to any other products that may appear to be authentic but were not distributed/sold by Capital Brands.

Normal wear and tear is not covered by this limited warranty. This limited warranty applies to consumer use only and is void when the product is used in a commercial or institutional setting.

This limited warranty gives you specific legal rights, and you may also have other rights which vary from state to state. Capital Brands is not liable for any damage to products not covered by this warranty (e.g., cups, book, User Guide).

This limited warranty does not apply: (a) to damage caused by accident, abuse, misuse, or misapplication; (b) to damage caused by improper maintenance (including unauthorized parts service); (c) to a product or a part that has been modified in any way; (d) if any magic bullet® Blender bar code or trademark has been removed or defaced; and or (e) if the product has been used with an adapter/converter.

In addition, proof of purchase and delivery must be demonstrated. Repair or replacement of the product (or, if repair or replacement is not feasible, a refund of the purchase price) is the consumer's exclusive remedy under this limited warranty. Capital Brands shall not be liable for any incidental or consequential damages for breach of this limited warranty or any implied warranty on this product. This limited warranty gives you specific legal rights, and you may also have other rights, which vary from state to state.

Capital Brands Distribution, LLC is not liable for any damage to products not covered by this warranty (e.g., cups, book, User Guide).

This limited warranty does not apply: (a) to damage caused by accident, abuse, misuse, or misapplication; (b) to damage caused by improper maintenance (including unauthorized parts service); (c) to a product or a part that has been modified in any way; (d) if any magic bullet® serial number, bar code, or trademark has been removed or defaced; and/or (e) if the product has been used with an adapter/converter or (f) commercial usage of this household product.

**THIS LIMITED WARRANTY AND THE REMEDIES SET FORTH ABOVE ARE EXCLUSIVE AND IN LIEU OF ALL OTHER WARRANTIES, REMEDIES AND CONDITIONS, WHETHER ORAL OR WRITTEN, EXPRESS OR IMPLIED. CAPITAL BRANDS DISTRIBUTION, LLC SPECIFICALLY DISCLAIMS ANY AND ALL IMPLIED WARRANTIES, INCLUDING, WITHOUT LIMITATION, WARRANTIES OF MERCHANTABILITY AND FITNESS FOR A PARTICULAR PURPOSE.**

**IF CAPITAL BRANDS DISTRIBUTION, LLC CANNOT LAWFULLY DISCLAIM IMPLIED WARRANTIES UNDER THIS LIMITED WARRANTY, ALL SUCH WARRANTIES, INCLUDING WARRANTIES OF MERCHANTABILITY AND FITNESS FOR A PARTICULAR PURPOSE ARE LIMITED IN DURATION TO THE DURATION OF THIS LIMITED WARRANTY.** No magic bullet® Blender reseller, agent, or employee is authorized to make any modification to this warranty.

**CAPITAL BRANDS DISTRIBUTION, LLC IS NOT RESPONSIBLE FOR DIRECT, SPECIAL, INCIDENTAL OR CONSEQUENTIAL DAMAGES RESULTING FROM ANY BREACH OF**

**WARRANTY OR CONDITION, OR UNDER ANY OTHER LEGAL THEORY, INCLUDING BUT NOT LIMITED TO LOST PROFITS, DOWNTIME, GOODWILL, DAMAGE TO OR REPLACEMENT OF EQUIPMENT AND PROPERTY. CAPITAL BRANDS DISTRIBUTION, LLC SPECIFICALLY DOES NOT REPRESENT THAT IT WILL BE ABLE TO REPAIR ANY PRODUCT UNDER THIS LIMITED WARRANTY.**

Some states and provinces do not allow the exclusion or limitation of incidental or consequential damages or exclusions or limitations on the duration of implied warranties or conditions, so the above limitations or exclusions may not apply to you. This limited warranty gives you specific legal rights, and you may also have other rights that vary by state or province.

# product *registration.*

Please visit [nutribullet.com/register](http://nutribullet.com/register) or call **1 (800) 523-5993** to register your new magic bullet® Blender. You will be asked to enter the **Serial Number\*** of your product, along with the purchase date and place of purchase. **The information you submit is for product registration. Failure to complete product registration does not diminish your warranty rights.**

The registration will enable us to contact you in the unlikely event of a product safety notification. By registering your product, you acknowledge that you have read and understood the instructions for use, and warnings set forth in the accompanying instructions.

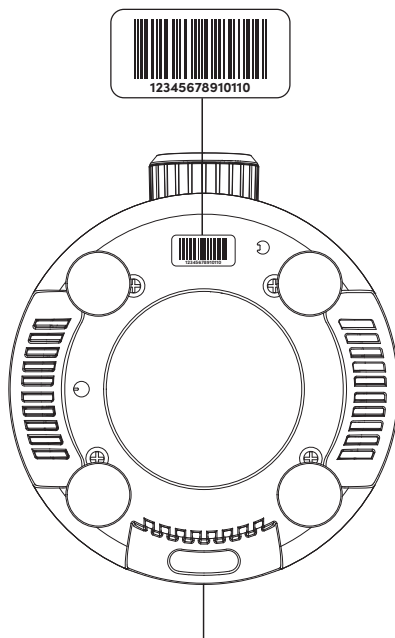

**\* You can find the serial number of your magic bullet® Blender under or on the back of the Motor Base. For further assistance, call customer service at 1 (800) 523-5993.**



**Capital Brands Distribution, LLC | [getmagicbullet.com](http://getmagicbullet.com) | All rights reserved.**

magic bullet® and the magic bullet logo are trademarks of CapBran Holdings, LLC, registered in the U.S.A. and worldwide.

Illustrations may differ from the actual product. We are constantly striving to improve our products, therefore the specifications contained herein are subject to change without notice.

**240118\_MBFXX100**